

2H75FVP-1 x 1

INTERIOR FLOOR TO WALL SYSTEM
 w/2 HOUR FIRE BARRIER: MBF2H0125
 UL LISTING: FF-S-0035
 MILL FINISH ALUMINUM BASE
 APPROXIMATELY 25% MOVEMENT

COLOR: _____
 FILLER COLORS AVAILABLE:
 BLACK, GRAY, TAN, OR BRONZE
 PLEASE SPECIFY
 NOTE: ONLY BLACK IS UV RESISTANT
 (FOR EXTERIOR USE)

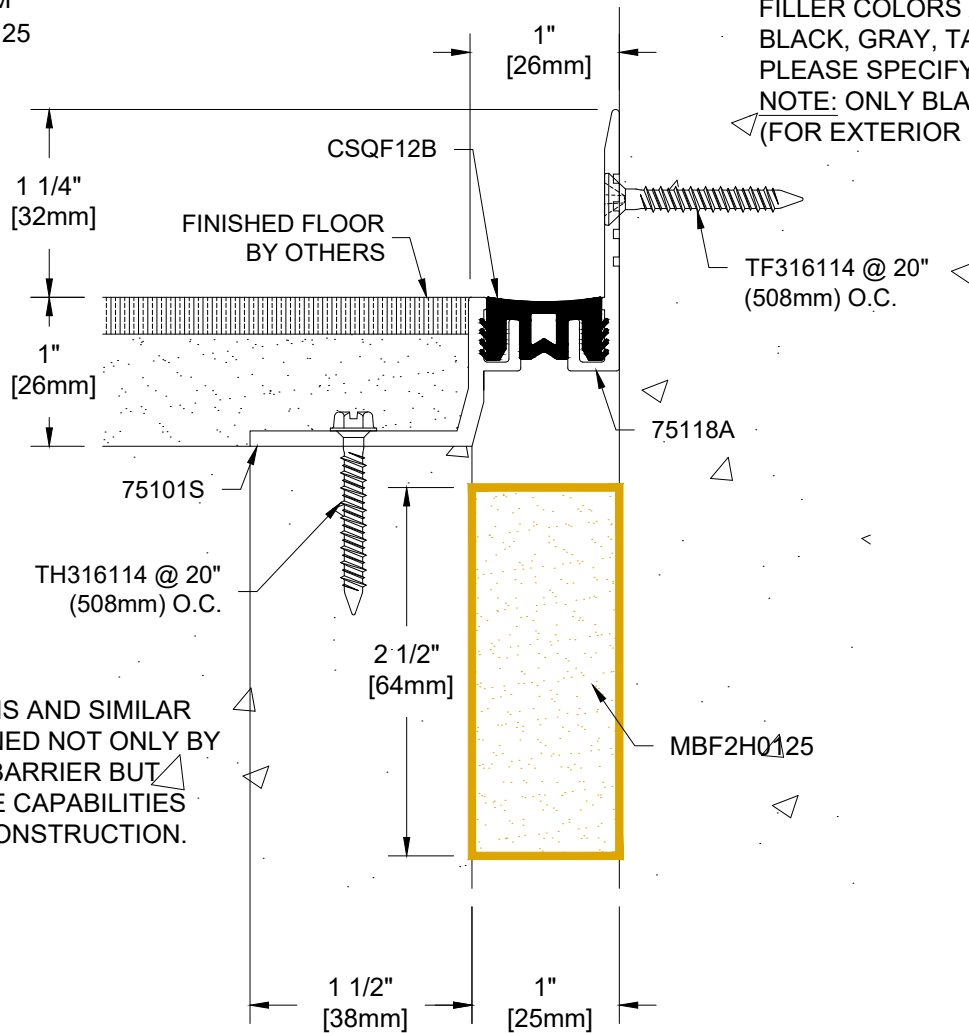

NOTE:
 THE FIRE RATING FOR THIS AND SIMILAR
 CONDITIONS IS DETERMINED NOT ONLY BY
 THE METABLOCK® FIRE BARRIER BUT
 ALSO THE PERFORMANCE CAPABILITIES
 OF THE SURROUNDING CONSTRUCTION.

Project:	
Customer:	
SO#	
Date:	
Page ___ of ___	Scale: NTS

Length	Qty.	Color

Drawn By: TSH

The information contained herein is the proprietary property of **BALCO, INC.** No portion of it may be reproduced by any means or used in any form except for the purpose for which it was furnished. All rights of design and invention are hereby reserved.



410 E 37th St N, Suite A
 Wichita, Kansas 67219 USA
 P: +1-316-945-9328 F: +1-316-945-0789