

# 2H75FP-1 x 2

INTERIOR FLOOR TO FLOOR SYSTEM  
 w/ 2 HOUR FIRE BARRIER: MBF2H0125  
 UL LISTING: FF-S-0035  
 MILL FINISH ALUMINUM BASE  
 APPROXIMATELY 25% MOVEMENT

COLOR: \_\_\_\_\_  
 FILLER COLORS AVAILABLE:  
 BLACK, GRAY, TAN, OR BRONZE  
 PLEASE SPECIFY  
 NOTE: ONLY BLACK IS UV RESISTANT  
 (FOR EXTERIOR USE)

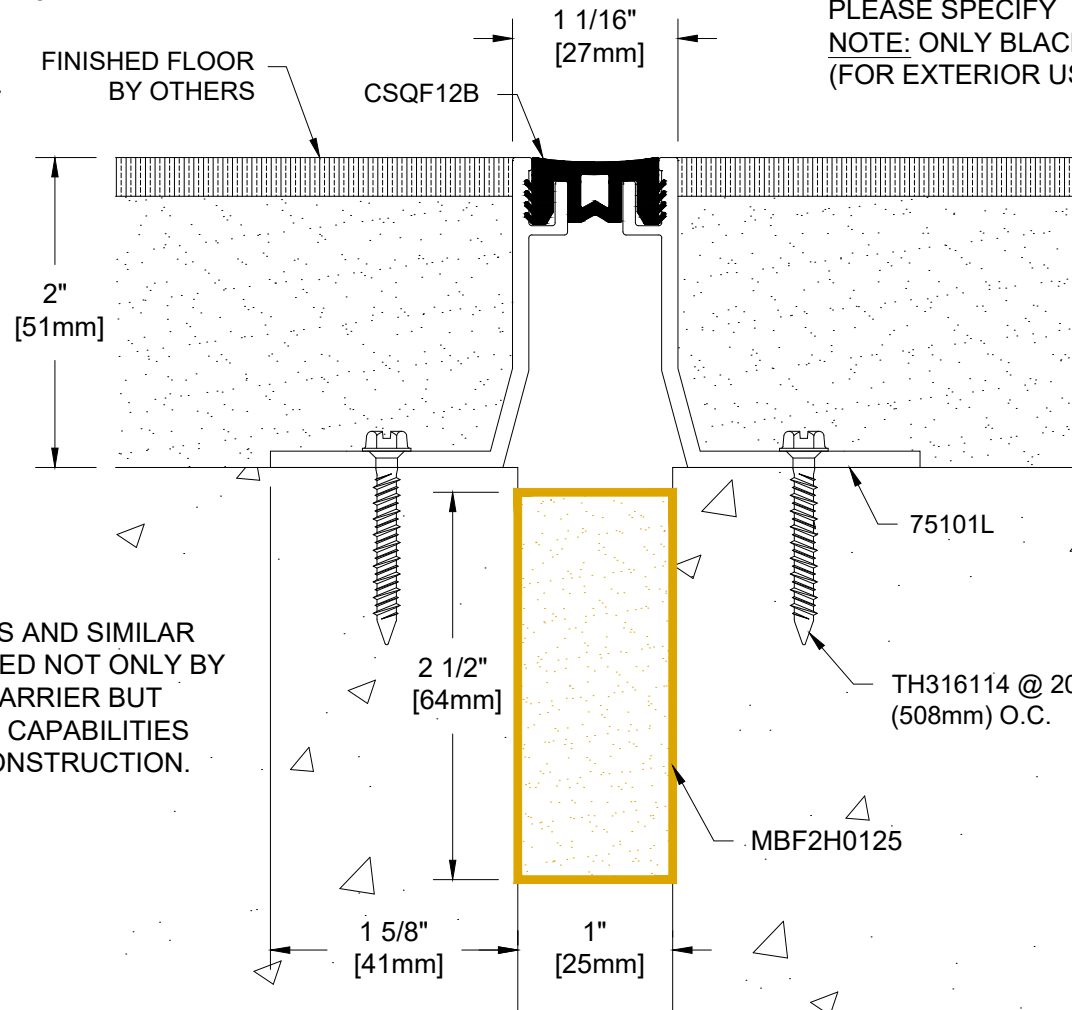

NOTE:  
 THE FIRE RATING FOR THIS AND SIMILAR  
 CONDITIONS IS DETERMINED NOT ONLY BY  
 THE METABLOCK® FIRE BARRIER BUT  
 ALSO THE PERFORMANCE CAPABILITIES  
 OF THE SURROUNDING CONSTRUCTION.

Project:	
Customer:	
SO#	
Date:	
Page ___ of ___	Scale: NTS

Length	Qty.	Color

Drawn By: RJT

The information contained herein is the proprietary property of **BALCO, INC.** No portion of it may be reproduced by any means or used in any form except for the purpose for which it was furnished. All rights of design and invention are hereby reserved.



410 E 37th St N, Suite A  
 Wichita, Kansas 67219 USA  
 P: +1-316-945-9328 F: +1-316-945-0789